

FREEHOLD



Flat - Purpose Built (EPC Rating: C)

185 MOTHERWELL ROAD, BELLSHILL, ML4 2JG

Offers over

£114,995

FEATURES

- Upper Cottage Flat
- Neutral Decor
- Private Section of Rear Garden
- Excellent Transport Links Nearby
- 3 Double Bedrooms
- Private Driveway
- Close to Amenities
- Early Viewing Recommended



SWEET HOME



3 Bedroom Flat - Purpose Built located in Bellshill

Sweet Home Scotland are delighted to present this spacious three-bedroom upper cottage flat, ideally located on Motherwell Road in Bellshill.

This well-proportioned home offers generous accommodation throughout and is presented in neutral décor, allowing the new owner to move straight in while adding their own personal touch.

The property comprises a bright and welcoming lounge, a well-appointed kitchen, a family bathroom, and three double bedrooms, providing excellent flexibility for a range of buyers including first-time buyers, families or investors.

Externally, the property further benefits from a private driveway with space for up to several vehicles and a large private section of rear garden, offering fantastic outdoor space for relaxing or entertaining.

Situated in a convenient location, the property is well placed for access to local amenities, schooling and excellent transport links, making it ideal for commuters.

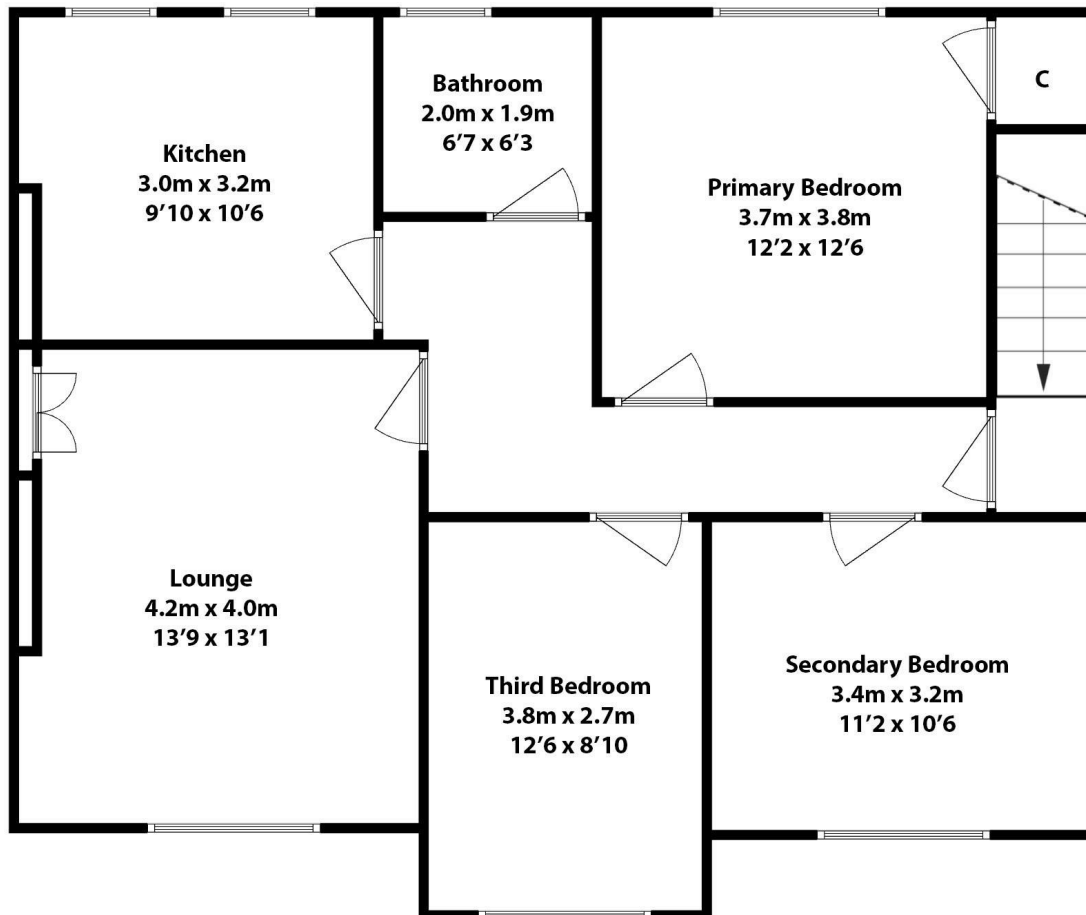

Call us on

01236 677500

sales@sweet-home.co.uk

<https://sweet-home.co.uk/>

Council Tax Band

A

Energy Efficiency Rating		Current	Potential
<i>Very energy efficient - lower running costs</i>			
(92 plus) A			
(81-91) B			
(69-80) C		71	75
(55-68) D			
(39-54) E			
(21-38) F			
(1-20) G			
<i>Not energy efficient - higher running costs</i>			
Scotland	EU Directive		
	2002/91/EC		

Agents Note: Whilst every care has been taken to prepare these particulars, they are for guidance purposes only. All measurements are approximate and are for general guidance purposes only and whilst every care has been taken to ensure their accuracy, they should not be relied upon and potential buyers are advised to recheck the measurements.

